

4

3

2

CAGEC 1K3H5 DWG NO 700167

SH 1 REV 1

1

REVISIONS			
REV	DESCRIPTION	DATE	APPROVED
1	Add I/O location	1/19/09	

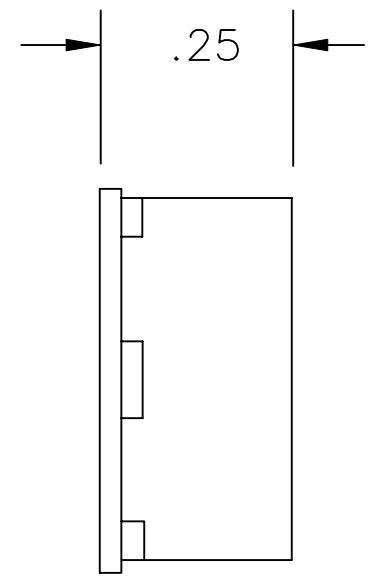
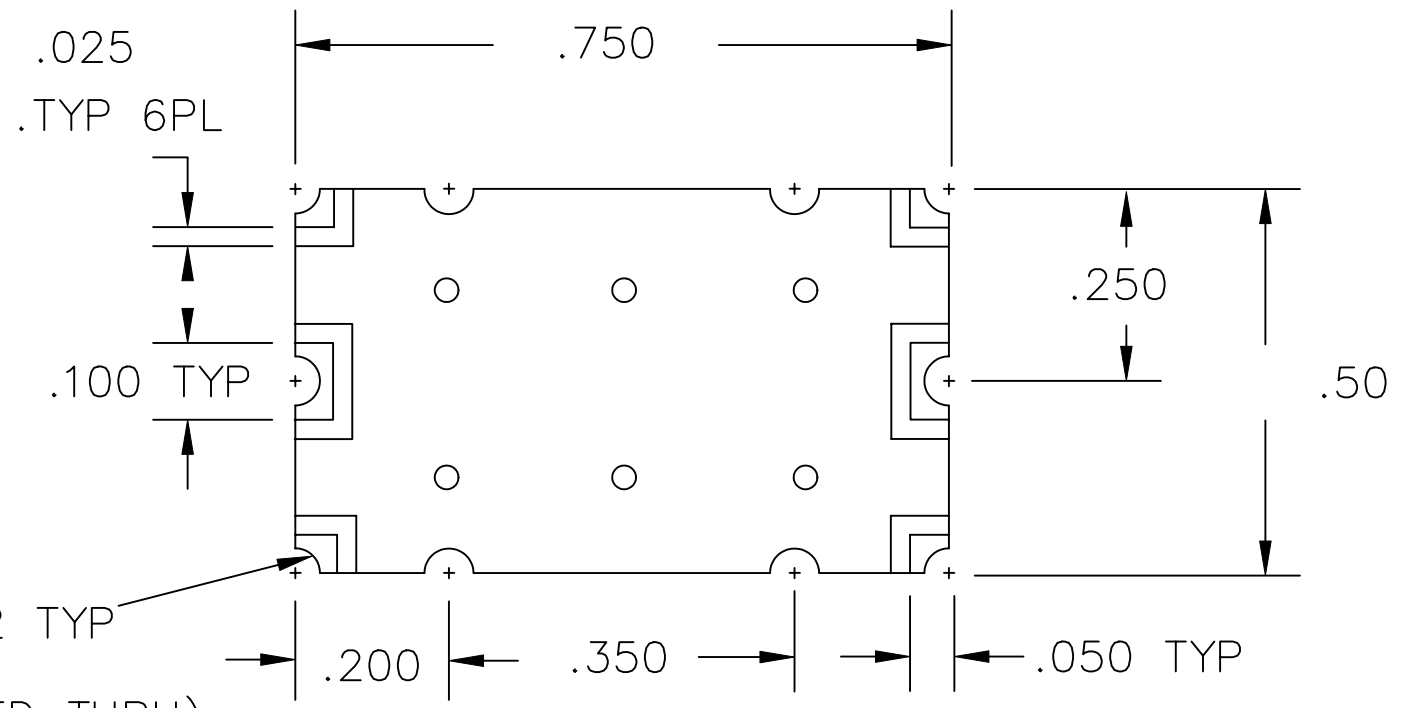

①
R .032 TYP
10 PL
(PLATED THRU)

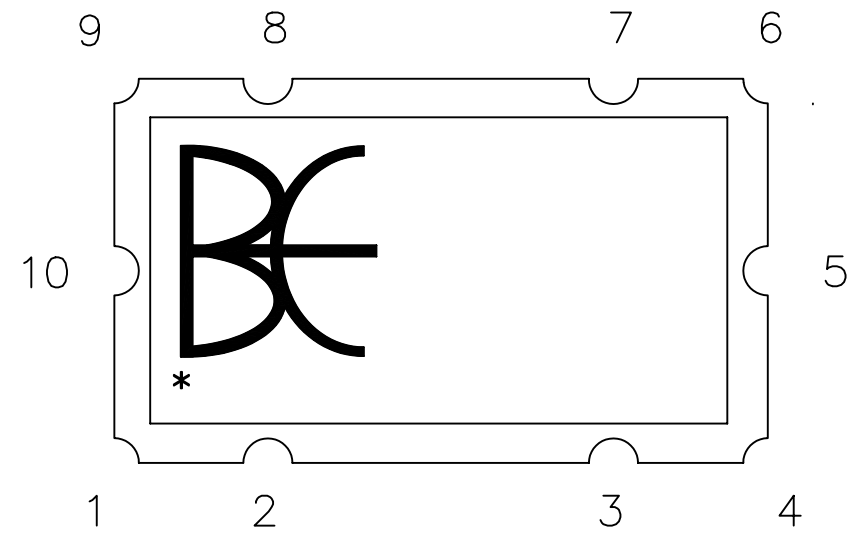

CONTACT I/O
(TOP VIEW)

2 RF I/O are 1-4 all others are ground.

① Location of plated thru holes are to be held at +/- .005.

THE INFORMATION CONTAINED IN THIS DRAWING IS THE SOLE PROPERTY OF BREE ENGINEERING. ANY REPRODUCTION IN PART OR WHOLE WITHOUT THE WRITTEN PERMISSION OF BREE ENGINEERING IS PROHIBITED.

UNLESS OTHERWISE SPECIFIED DIMENSIONS ARE IN INCHES & TOLERANCES ARE: .XXX .XX ANGLES ±.005 ±.01	CAD GENERATED DRAWING DO NOT MANUALLY UPDATE		BEE BREE ENGINEERING
	DWN LN	DATE 12/4/08	
MATERIAL PCB-FR4 / NICKEL	CHK BE	DATE 12/4/08	OUTLINE for 802454 & 802455
	RESP ENG		
	MFG ENG		
MATERIAL N/A	QUAL ENG		
	Scale for REFERENCE ONLY		
	SIZE B	CAGE CODE 1K3H5	DWG NO 700167
	SCALE 4:1		REV 1
			SHEET 1 OF 1

4

3

2

1

B

B

A

A